

IMPORTANT THINGS TO REMEMBER DURING THE INSTALLATION OF YOUR SHOWER SYSTEM

1

Important to follow the installation manual(s).

2

The plastic cover must be used to determine the depth of the valve and the diameter of the cut-out hole.

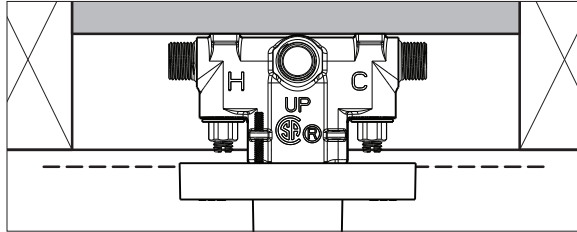

3

Starting with the color line on the cartridge, align all the color lines found on the subsequent parts.

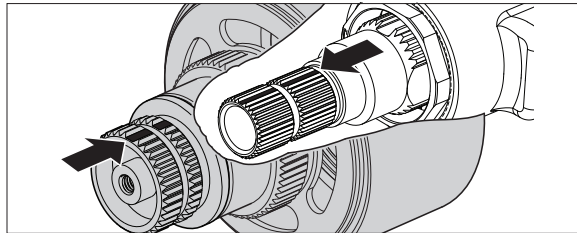

4

Hot water supply on left and cold water supply on right.

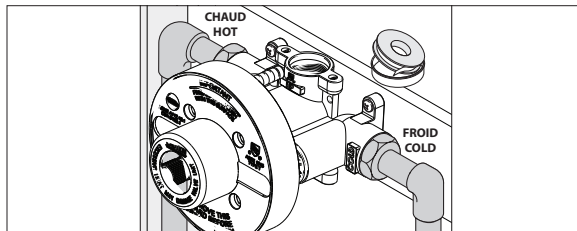

5

Remove cartridge and check valves if and before welding copper conduits (allow to cool).

6

Purge lines to clear debris and reinstall or replace the cartridge.

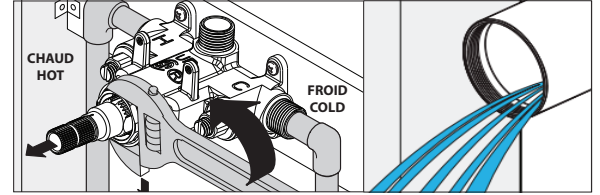

7

Before closing the walls, test the temperature manageability and watch for leaks.

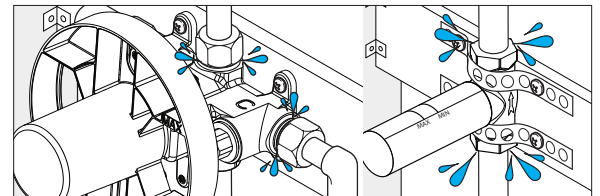

8

Make sure the 2 pegs are at 6 o'clock when reinserting into valve body.

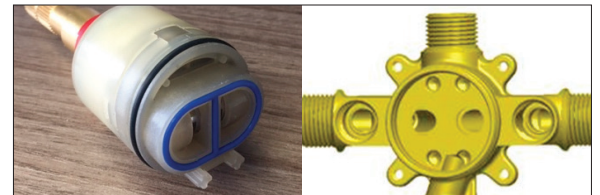

9

If installing two valves back to back using the same supply lines, make sure to reverse cartridge in the second valve.

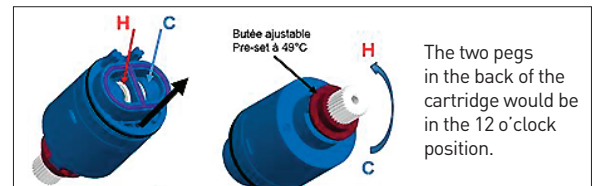

Call Kalia if you need assistance or if you have any questions: 1-877-465-2542 or email at service@kaliastyle.com.

→ Please have in hand your product codes or installation manuals.

KEEP ALL INSTALLATION INSTRUCTION MANUALS FOR THE END-USER IF NEEDED FOR FUTURE REFERENCE.