

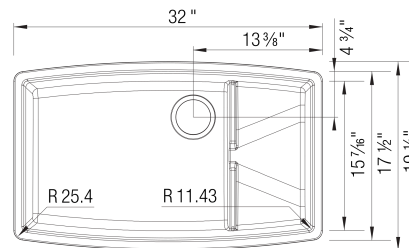

## Sink Specifications

Colour	SKU
Anthracite	400886
Café	400887
Truffle	401191
Cinder	401420
Metallic Gray	401708
White	402141
Coal Black	402661
Soft White	402885
Volcano Gray	402930

## PERFORMA Cascade SILGRANIT



### Design and planning tips

- Min cabinet size: 36 in ( 915 mm )

#### Specifications:

Mesh basket, 3 1/2" stainless steel strainer(s),  
Installation instructions, Cut-out template, Limited  
Lifetime Warranty

To protect from damage, sink must ship on a  
pallet

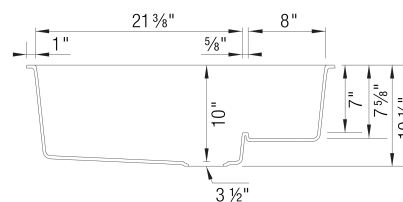

### Included Accessories

Mesh Basket	406461
-------------	--------

### Codes & Standards

CSA B45.8-18/ IAPMO Z403-2018

### Optional Accessories

Sink Grid	406449
CapFlow Strainer Cover	517666

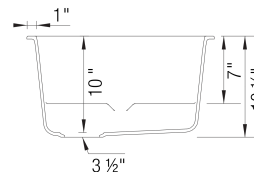

### Warranty

Limited lifetime warranty on all sinks and faucets. One-year warranty on all accessories and soap  
dispensers.

### Code/Standards Compliance

BLANCO sinks and faucets are third-party tested and certified to CSA, cUPC, ANSI/ASME, IAPMO  
and NSF standards and listed by applicable certification bodies. For more information on individual  
product listings, contact our office or listing organization.



Need support? Learn more by watching our sink & faucet How-to videos:

<https://www.blanco.com/ca-en/support/how-to-videos/how-to-videos-for-sinks/>



BLANCO Canada Inc  
100 Corporation Drive  
Brampton ON L6S 6B5

#### Tel & Fax

Tel: 905-494-2400 Toll free: 1-877-425-2626  
Fax: 905-494-2425 Toll free: 1-877-825-2626

While BLANCO strives to provide accurate information, all images and dimensions in this document are intended for reference  
only and are subject to change at any time without notice. This document is not intended for use as an installation guide. For  
technical installation details, refer to installation instructions provided with the product. BLANCO assumes no responsibility for  
the use of superseded or voided specifications.