

INSTALLATION INSTRUCTIONS



Lowell™ Towel Bar  
Model D28005

Thank you for selecting DXV by American Standard... fifteen decades of design and inspiration. To ensure that your installation proceeds smoothly, please read these instructions carefully before you begin.



RECOMMENDED TOOLS AND MATERIALS

Most of the procedures require the use of common tools and materials, which are available from hardware and plumbing, supply stores. It is essential that the tools and materials be on hand before work is begun.



Phillips Screwdriver

1 INSTALLATION

Insert well nuts in proper holes in lavy, hold flat mounting surface against lavy and tighten screws until bar is secure (do not overtighten).

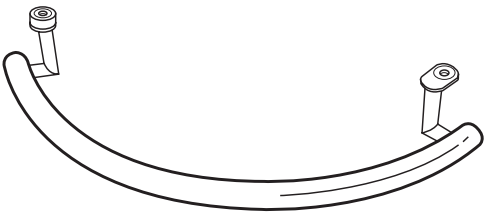
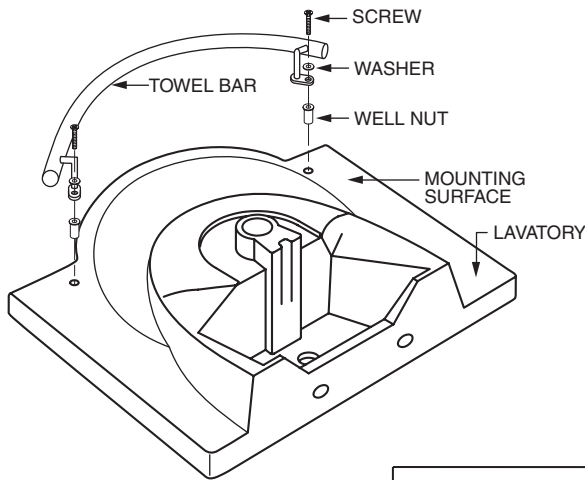

	PART No.	MOUNTING KIT PROVIDED
LOWELL PEDESTAL LAVATORY TOWEL BAR	D28005000.100	7381164-100.0070A

In the United States:

DXV by American Standard  
One Centennial Avenue  
Piscataway, New Jersey 08855  
Attention: Director of Customer Care

For residents of the United States, warranty information may also be obtained by calling the following toll free number: (800) 227-2734  
[www.DXV.com](http://www.DXV.com)

In Canada:

DXV by American Standard  
5900 Avebury Road  
Mississauga, Ontario  
L5R 3M3  
Canada

Toll Free: 1-800-387-0369  
Local: 905-306-1093  
Fax: 1-800-395-1498  
[www.DXV.ca](http://www.DXV.ca)

In Mexico:

DXV by American Standard  
Via Morelos 330  
Col. Santa Clara Coatitla  
Ecatepec, Estado de México 55540

Toll Free: 01-800-8391200  
[www.DXV.mx](http://www.DXV.mx)