

UNDERMOUNT SINK: UCS4608/316P-1

UCS4608/316P-1 | 2000102508

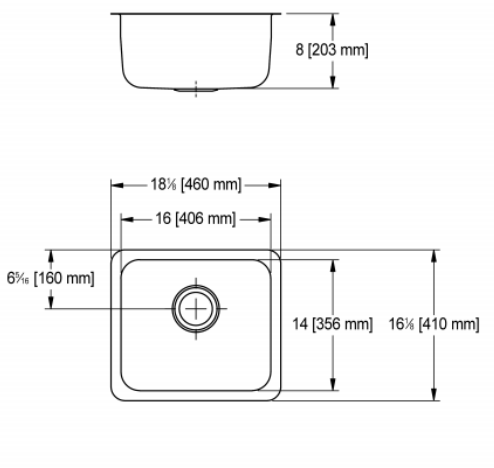

Single compartment undermount sink. 18 gauge (1.2 mm), type 316 (EN1.4401 17/12/2) stainless steel. Exposed surfaces are #4 satin finished. Undercoated to reduce condensation and resonance. Includes waste fitting, cutout template, and installation hardware. Certified to ASME A112.19.3-2008 / CSAB45.4-08.

Center waste location, 3 1/2" (89 mm) type 316 (EN1.4401 17/12/2) stainless steel crumb cup strainer with 1 1/2" (DN38) type 316 (EN1.4401 17/12/2) stainless steel tailpiece.

TECHNICAL DATA	
type of basin	Single Compartment
bowl depth	8"
Bowl finish	SATIN-FINISHED
Bowl front to back	14"
bowl shape	rounded rectangle
Bowl left to right	16"
gross weight	4.73 kg
material	STAINLESS-STEEL
material code	1.4404 Chrome-Nickel-Molybdenum steel V4A
material thickness	1/16"
material thickness grade	18 gauge (1.2 mm)
Overall front to back	16 1/8"
overall height	8"
Overall left to right	18 1/8"
overflow	no
rear upstand	no
back splash	no
Cabinet finish	satin finished
Faucet ledge	No
type of mounting	undermount
waste hole position	centre
waste kit included	yes
waste size	DN 40
net weight	3.36 kg

PROJECT INFORMATION

Item Location

Project Number

Quote Number

Notes

Engineer's Approval



