

Aspen Technical Specification

Robe Hook

5802

Stock Numbers:

- ❑ **5802CH – Robe Hook**
Polished Chrome Finish,
Concealed Screw Mounting.
- ❑ **5802W – Robe Hook**
White Finish,
Concealed Screw Mounting.

Dimensions:

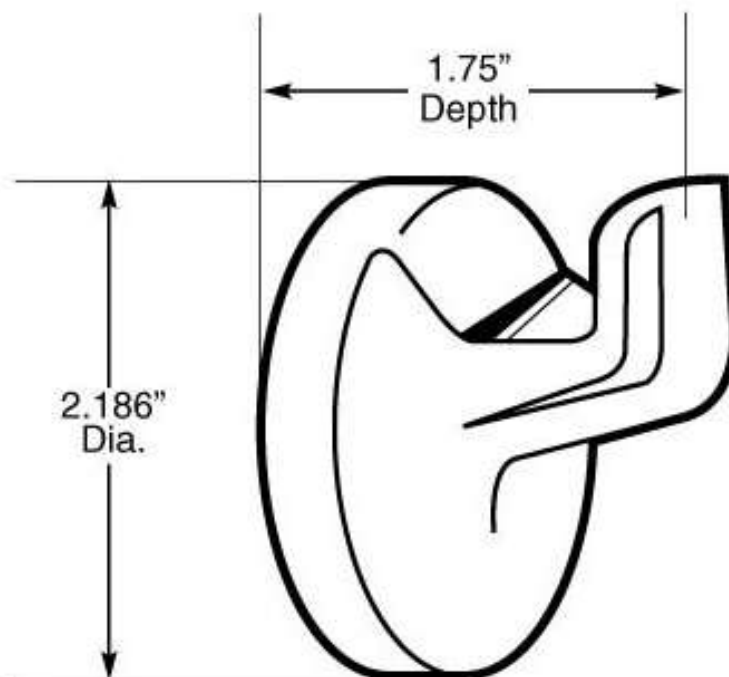

Materials:

Robe Hook is die cast from highest quality zinc alloy (zamac). Castings are triple plated with a polished chrome or a powder coated white finish.

Installation Instructions:

1. Position the mounting plate on the wall at desired location with "UP" facing you.
2. One at a time, place each anchor screw through the mounting plate, centered in each large hole. Using a Phillips screwdriver, turn the anchor screw while applying pressure. Screw will self drill and tap into dry wall. Do not over tighten.
3. Place assembly over the mounting post, setscrew facing down.
4. Tighten setscrew.

Cleaning Instructions:

To preserve the fine finish of this product, clean only with a soft damp cloth. Dry well. Do not use commercial or abrasive cleaners.

Stock Number: _____ **Robe Hook**
By Creative Specialties



25300 AL MOEN DRIVE • NORTH OLMSTED, OH 44070 (800) 321-8809 •
FAX: (800) 848-6636 • INTERNATIONAL: (440) 962-2000 •
FAX: (440) 962-2726 CUSTOMER SERVICE (USA): 800-882-0116
WWW.MOEN.COM
©Copyright Creative Specialties International Literature #BA0965