



## Specifications

### DESCRIPTION

- Metal construction with various finishes identified by suffix
- Includes showerhead, arm, flange and diverter tub spout
- Pressure balancing cycle valve design with an adjustable temperature limit stop

### OPERATION

- Handle operates counterclockwise through a 270° arc with off at 6 o'clock and maximum hot at the 9 o'clock position. Shut off in clockwise direction
- Adjustable temperature limit stop to control maximum hot water temperature
- Pressure balancing mechanism maintains selected discharge temperature to  $\pm 3^\circ \text{F}$

### FLOW

- EP suffix models are limited to 1.75 gpm (6.6 L/min) at 80 psi

### CARTRIDGE

- 1222 cartridge design
- Nonmetallic/nonferrous and stainless steel materials
- Accommodates back to back installations

### STANDARDS

- Third party certified to meet ASME A112.18.1/CSA B125.1 and all applicable requirements referenced therein
- EP suffix models are third party certified to WaterSense®
- ADA ♿ for lever handle

### WARRANTY

- Lifetime limited warranty against leaks, drips and finish defects to the original homeowner
  - 10 year limited warranty when used in a multifamily installation
  - 5 year limited warranty when used in a commercial installation
- Visit [www.moen.com/support](http://www.moen.com/support) for complete details and limitations

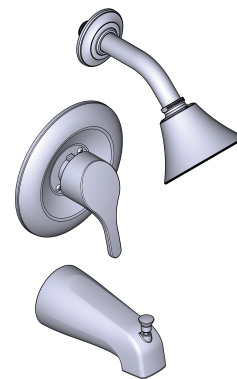

### KLIO™ POSI-TEMP® Single-Handle Tub/Shower Trim Kit

Models: T62481 (Bulk Packed 12 per carton)  
T62482 (Bulk Packed 12 per carton)  
T62483 (Bulk Packed 12 per cartridge)

Valves: 62300 series  
2500 series

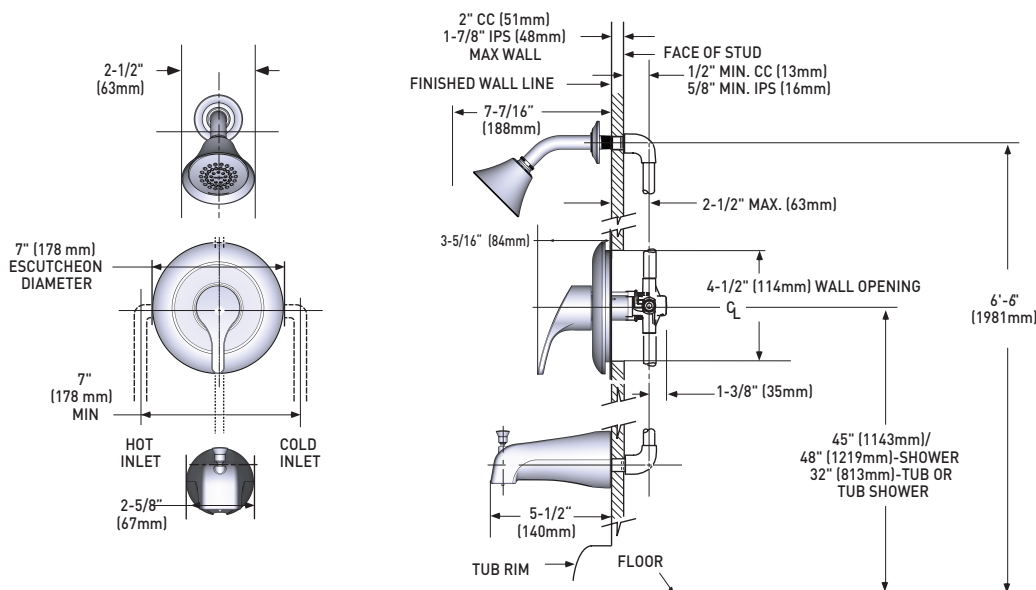

THICK WALL APPLICATION

### Models Only

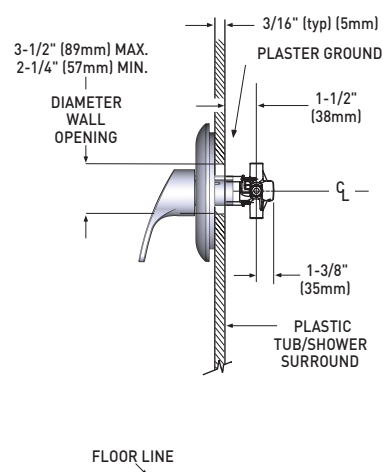

THIN WALL APPLICATION

CRITICAL DIMENSIONS DO NOT SCALE