

**Starck 3 Toilet Seat # 0063890000**

|&lt; 14 5/8 " &gt;|

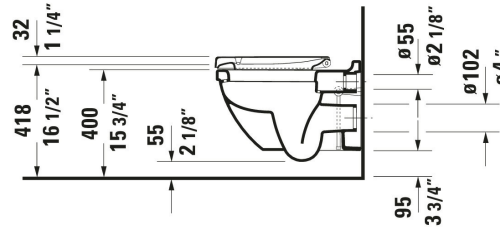

Toilet Seat	Dimension	Weight	Order number
Slow close: Yes, Removable Seat, Hinge material: Stainless Steel			
<b>Colors</b>			
00 White			
<b>Variant</b>			
Shape: D-shaped, White High Gloss, Hinge color: Stainless Steel, Wrap over	14 5/8 "x1 3/4 "	4.630 lb	0063890000
<b>Suitable products</b>			
Toilet Bowl Flush water quantity: 1.2/0.8 gal, Washdown model, Flushing rim: Closed, Outlet: horizontal, vertical, Position outlet: Rear, Includes tank: No, Flush system: Siphonic, For bowl mounted tank, Adjustable length, Hardware included, cUPC listed: Yes, 14 5/8 x 26 "	14 5/8 x 26 "		012809
Wall Mounted Toilet Flush water quantity: 1.2/0.8 gal, Washdown model, Flushing rim: Closed, Flush system: washdown model, Outlet horizontal, Concealed fixation, ADA: Yes, cUPC listed: Yes, 14 3/8 x 21 1/4 "	14 3/8 x 21 1/4 "		222509
Wall Mounted Toilet Compact Flush water quantity: 1.2/0.8 gal, Washdown model, Flushing rim: Closed, Flush system: washdown model, Outlet horizontal, Concealed fixation, cUPC listed: Yes, 14 3/4 x 19 1/8 "	14 3/4 x 19 1/8 "		222709
Wall Mounted Toilet Flush water quantity: 1.2/0.8 gal, Washdown model, Flushing rim: Rimless, Flush system: washdown model, Outlet horizontal, Concealed fixation, ADA: Yes, cUPC listed: Yes, 14 3/8 x 21 1/4 "	14 3/8 x 21 1/4 "		252709

All drawings contain the necessary measurements which are subject to standard tolerances. They are stated in inch & mm and are non-binding. Exact measurements, in particular for customized installation scenarios, can only be taken from the finished ceramic piece.