

# Installation Manual



## Advanced Clean 3.0 SpaLet<sup>®</sup> Bidet Seat Model: 8018A60GRC

Thank you for purchasing this product.

<b>CAUTION</b>	<ul style="list-style-type: none"><li>• Carefully read this installation manual to install this product correctly.</li><li>• Be sure to test operation after installation has been completed.</li></ul>
----------------	---

<b>Installation Procedure</b>	
<b>1 Check the "Installation Requirements" .....</b>	<b>P.6</b>
↓	
<b>2 Install the junction fitting.....</b>	<b>P.11</b>
↓	
<b>3 Installation of water supply hose to the SpaLet<sup>®</sup> seat .....</b>	<b>P.12</b>
↓	
<b>4 Installation of the SpaLet<sup>®</sup> seat .....</b>	<b>P.13</b>
↓	
<b>5 Install the water supply hose (junction fitting side).....</b>	<b>P.14</b>
↓	
<b>6 Positioning and Mounting the Remote Control .....</b>	<b>P.15</b>
↓	
<b>7 Test Operation .....</b>	<b>P.17</b>

# 1. Important Safeguards

When using electrical products, especially when children are present, the basic safety precautions should always be observed.

## **READ ALL THE INSTRUCTIONS BEFORE USING THIS PRODUCT**

The following safety terms are used in this manual to warn against different hazardous situations:

DANGER indicates an imminently hazardous situation which, if not avoided, will result in death or serious injury.

WARNING indicates a potentially hazardous situation which, if not avoided, could result in death or serious injury.

CAUTION indicates a potentially hazardous situation which, if not avoided, may result in minor or moderate injury or in damage to the product or other property.



**DANGER**

### **To reduce the risk of electric shock:**

1. All electrical installation work must be carried out by a qualified electrician.
2. Install a secure ground connection, following the grounding instructions (see page 7)
3. Do not place or store product where it can fall or be pulled into a tub or sink.
4. Do not place on or drop into water or any other liquid.
5. Do not pour water or cleanser inside this product. Do not splash water or cleanser on the body or the power plug.
6. Do not reach for a product that has fallen into water. Unplug immediately.
7. Do not allow anyone except an authorized service technician to disassemble, repair or modify this product. If repairs are necessary, contact our company.



**WARNING**

### **To reduce the risk of burns, electrocution fire, or injury to persons:**

1. When small children, elderly persons, persons with limited mobility or people with illness are using this product, ensure that the proper operating procedures are followed at all times to ensure the user's safety.
2. When you are using this product for a long period of time, set the seat temperature to "Off".  
For the following persons, be sure to set the seat temperature to "Off" when they are using this product.  
(Children, elderly persons, persons with illness, persons with limited mobility, persons with sensitive skin, persons who are taking medicines that cause drowsiness, persons who are intoxicated, or persons who are extremely fatigued.)

\* Using the SpaLet® seat for a long period of time without setting the seat temperature to "Off" may result in low temperature burns.

### Low Temperature Burns

A low temperature burn may occur when the skin has been in contact for some time with an object at relatively low temperature (about 104 °F [40 °C]). Susceptibility to burns also depends on an individual's skin sensitivity and other factors.

3. This product should be used only as described in this manual. Do not use attachments that are not recommended by the manufacturer.
4. Never operate this product if it has a damaged cord or plug, if the plug is loose in the outlet, if it is not working properly, or if it has been dropped or damaged. Please contact our company for instructions on resolving any of the above issues.
5. Keep the cord away from heated surfaces. (Example: Panel Heater)
6. Never block the air openings of the product. If lint or hair, etc. is stuck in the air openings, remove it immediately.
7. Never use while sleeping or feeling drowsy.
8. Never drop or insert any object into any opening or hose.
9. Do not use outdoors or operate where aerosol (spray) products are being used or where oxygen is being administered.
10. Connect this product to a properly grounded outlet only. See Grounding Instructions.
11. This product should only be connected to a potable water supply line. Failure to do so will cause problems in the operation.
12. Do not pull out or insert the power plug with wet hands.
13. Disconnect the power plug periodically and clean it with a dry cloth. Dust accumulated on the power plug may cause fire.



### CAUTION

#### **To reduce the risk of minor injury or property damage:**

1. This product should only be connected to a 120 V AC, 60 Hz GFCI-protected outlet.
2. Be sure to set the dry temperature to "Low" when the following persons use the SpaLet® seat.  
(Children, elderly persons, persons with illness, persons with limited mobility, persons with sensitive skin, persons who are taking medicines that cause drowsiness, persons who are intoxicated, or persons who are extremely fatigued.)  
\* If the dryer is used for a long period of time on a setting higher than "Low", the user may risk a low temperature burn. For this reason, our company recommends setting the dryer temperature to "Low" during use.

3. For care of the plastic parts, our company recommends the use of a mild, liquid, all-purpose cleaner. Avoid using abrasive products (such as powdered cleansers) and chlorine-based products (such as bleach), as these products can damage the anti-bacterial properties of the plastic components.
4. If the SpaLet<sup>®</sup> seat or the body cover is damaged, pull the power plug out of the outlet and contact our company to request repairs.
5. Do not stand on the seat lid, as it may break.
6. Do not lean back against the seat lid during use, as this may damage or break the seat lid.
7. Install this product according to this installation manual. Improper installation may result in electrocution, fire, or a water leak.
8. If it is necessary to change the electrical wiring or plumbing (including items for which installation is not restricted, such as a ground fault circuit breaker), have an electrician or plumber who has undergone training in accordance with federal, state or local laws and regulations and has obtained the proper license, perform the required construction work.
9. If you will not be using this product for an extended period of time, close the water shut-off valve and drain the water from the SpaLet seat. In addition, disconnect the power plug from the outlet.
10. Avoid using front and back cleansing functions excessively or for long periods of time as such overuse may increase the possibility of washing away desirable resident bacteria and causing an imbalance of bacteria in your body. If you are pregnant, are being treated for a gynecological condition, develop excessive irritation in the area of use, or if you have questions, please speak to your doctor before beginning or continuing use of the product.

**SAVE THESE INSTRUCTIONS**

## 2. Product Description

---

This product incorporates a set of features to improve personal toilet hygiene and comfort. These features include back cleansing, front cleansing, a warm air dryer and a seat heater as well as the required controls for these features.

This product includes a SpaLet seat® unit (with heated SpaLet seat, seat lid, and power cord), hardware for installing the SpaLet seat unit on a toilet bowl and connecting it to the water supply and this installation and user manual.

This product incorporates the following features:

- back cleansing with water flow strength controls
- front cleansing with water flow strength controls
- warm air dryer with air temperature controls
- seat heater with heat level control
- back and front cleansing water temperature control
- seat and water temperature indicators
- back and front nozzle self-cleaning
- stop button for back cleansing, front cleansing and dryer

**Note:**

- When transporting the product, take care not to inadvertently bump or drop it.
- This product has been already inspected using tap water. A small amount of water may be detected when installing the unit; this should not be a cause for concern.

# 3. Installing This Product

## Installation Requirements

Before installing this product, ensure that each of the following installation requirements are met.

### Contents

Remove the parts from the box and make sure all the parts in the parts list (below) are present. Inspect the parts carefully to make sure they are in good condition. If any part is damaged or missing, do not install this product. Contact the nearest customer service representative for the part(s) you need.

The following parts are included:

- SpaLet® seat unit (with heated seat, seat lid and power cord)
- Mounting plate
- Manual set
- Mounting bolts, washers, and bushings (2 pieces each)
- Junction fitting (with a packing)
- SpaLet seat unit water supply hose (with 2 clips)
- Remote control
- Holder
- Batteries
- Wood screw
- Plastic anchors

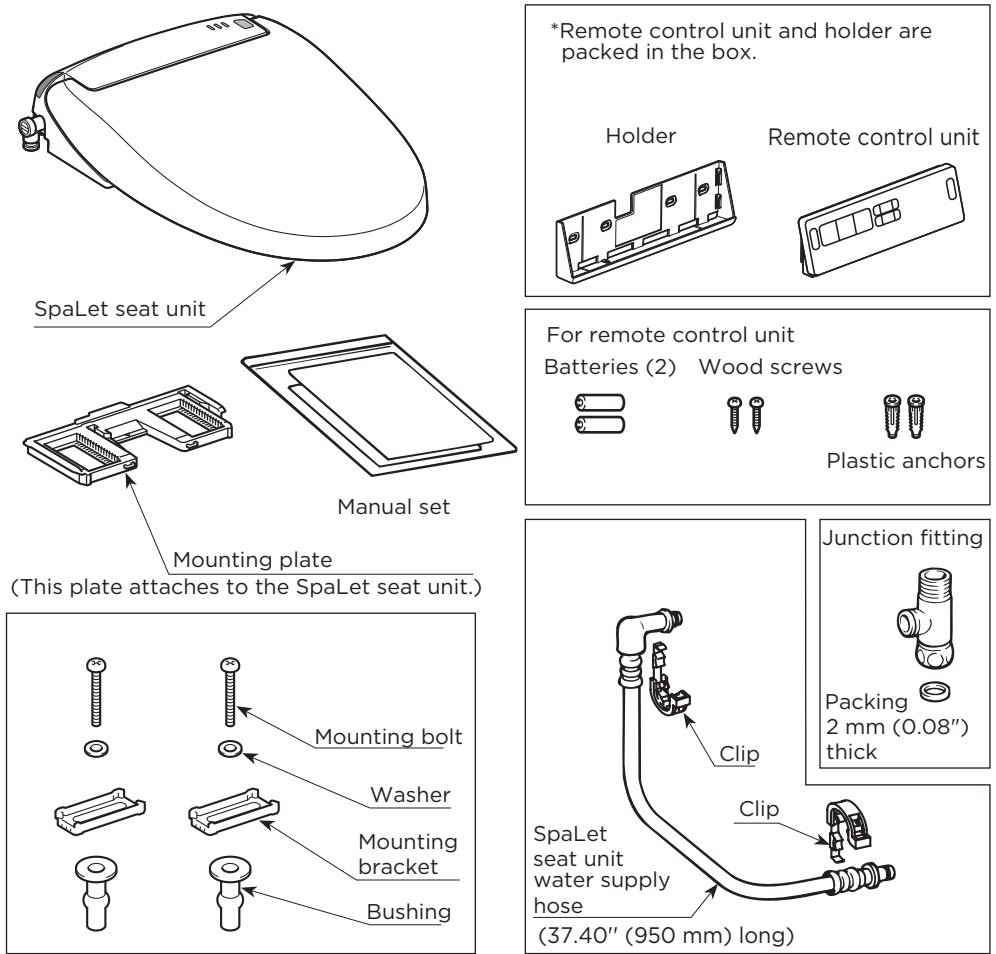

## Ground Fault Circuit Breaker

A ground fault circuit breaker must be installed in the circuit that supplies power to this product.

## Power Supply

This product is for use on a nominal AC120 V circuit. Use a AC120 V, 60 Hz power supply. The maximum power consumption is 1300W. Electrical wiring must be installed that meets these specifications. The plug outlet shall be placed in an accessible location after installation.

## Grounding

This product must be grounded. In the event of an electrical short circuit, grounding reduces the risk of electric shock by providing an escape wire for the electric current. The power cord has a grounding wire and a three-prong grounding plug (shown below). Do not use an adapter with the product's power plug, or use any other unauthorized method to connect the plug to an improperly configured outlet.

The outlet to which the product is connected must be AC120 V, 60 Hz, with a minimum electrical rating of 3 A. The outlet must be properly installed and grounded, and it must be a three-slot outlet (shown below).

**DANGER: Improper use of the grounding plug may cause an electric shock.**

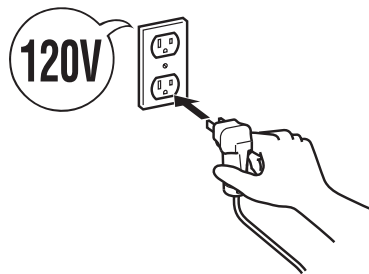

## Installation Location

In order to prevent damaging the electronic components, install this product at a location that minimizes the possibility of it getting wet. In extremely humid conditions, provide adequate ventilation by operating an exhaust fan or opening a window or door.

## Water Supply

Use only the tap water line to supply water to this product. The use of any other type of water i.e. ground water may cause improper operation of this product.

The tap water pressure must be 8.5 to 106.7 psi (0.06 to 0.74 MPa, 0.6 to 7.5 kgf/cm<sup>2</sup>).

## Checking the Bathroom

The dimensions required for mounting this product on a toilet bowl are shown in the figure below. Check to make sure there is sufficient space inside the bathroom and that there are no obstructions.

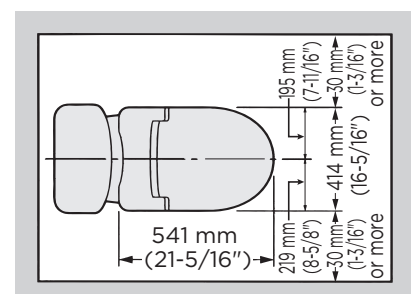

# Checking the toilet bowl

## 1. Measure the size of the toilet bowl.

Depending on the size of the toilet bowl, it may not be possible to mount this product on it. Make sure the toilet bowl's dimensions are as shown in the figure on the right.

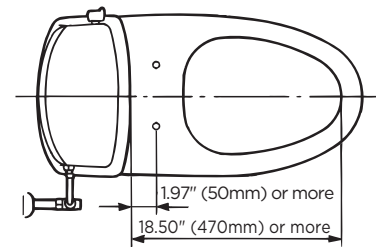
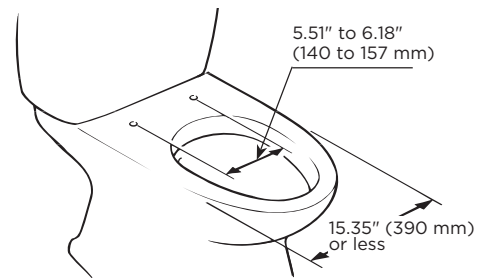

## 2. Conditions for using SpaLet® seat unit water supply hose (included)

The length of the SpaLet seat unit water supply hose included with this product is 37.40" (950 mm), but a length of 31.50" (800 mm) from the junction fitting to the SpaLet seat unit's water supply socket is appropriate. (Refer to the figure on the right)

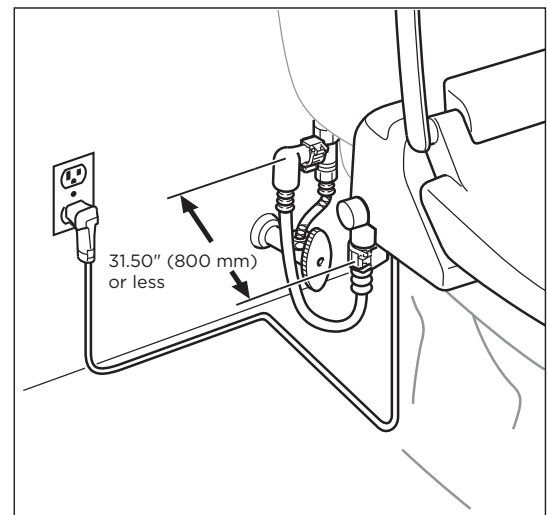



# Illustrated Parts Breakdown

## Overview

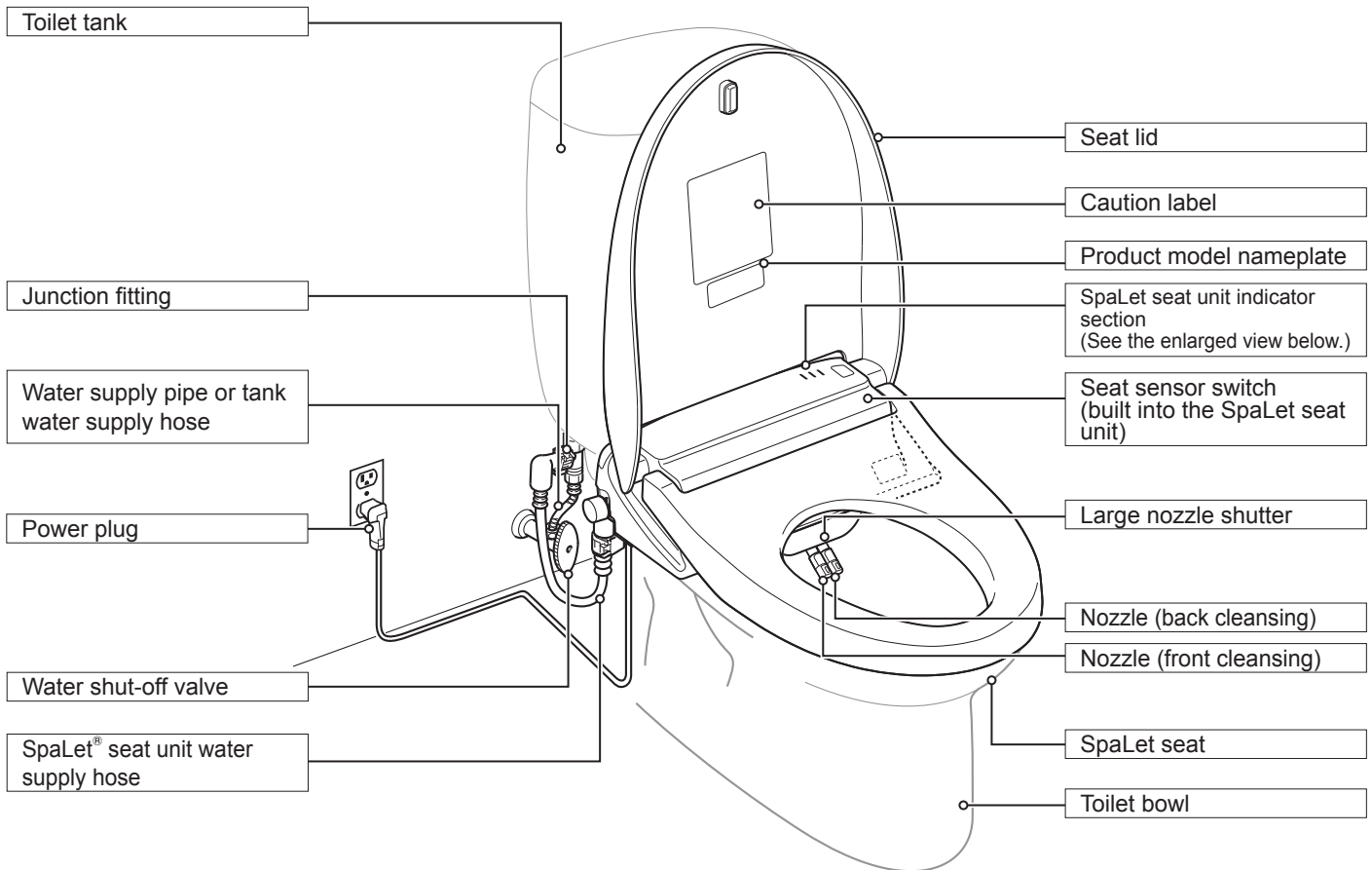
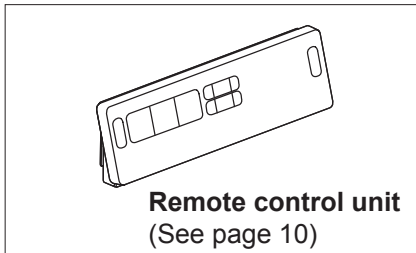

## Indicator Panel

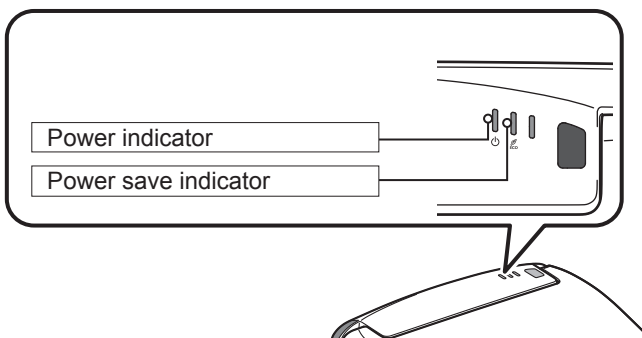

## Filter

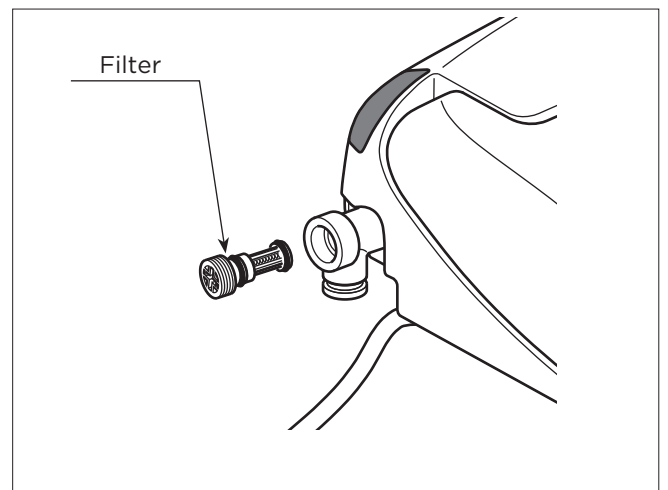

# Remote Control

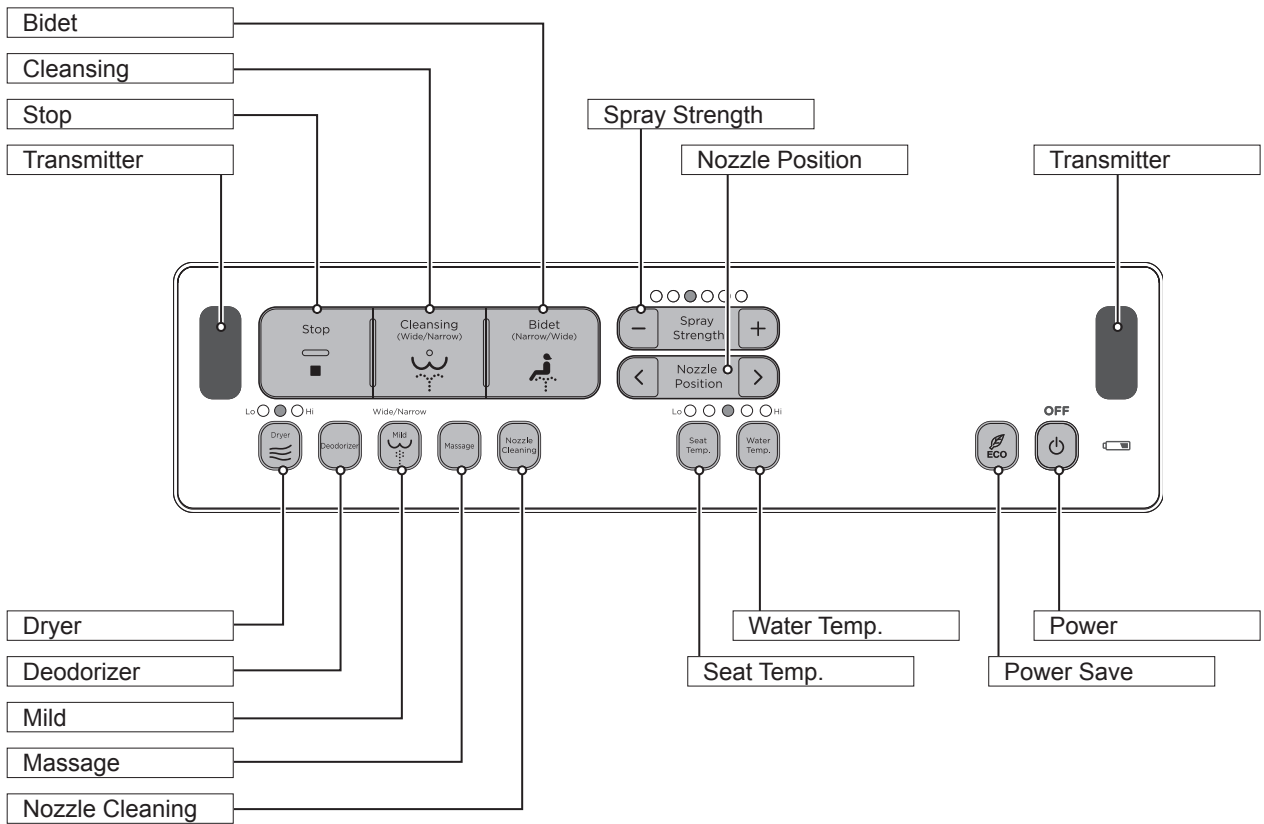

# Mounting Plate

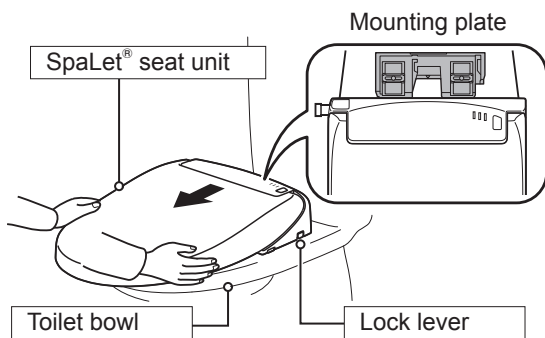

\* The mounting plate is used to remove the SpaLet seat unit from the toilet bowl for cleaning and maintenance. (Page 13)

# Installation

## 1. Required tools

Have the following tools for installing this product: adjustable end wrench, Phillips head screwdriver, flat-blade screwdriver.

## 2. Install the junction fitting

- (1) Close the toilet water shut-off valve fully.
- (2) Flush the toilet and empty all the water from the toilet tank.
- (3) Place a wash bowl or other container underneath the tank water supply hose. Then loosen the box nut on the toilet tank inlet side and remove it.

### CAUTION

- Be careful not to damage the tank water supply hose.

- (4) Place the packing in the junction fitting box nut and connect the toilet tank inlet to the junction fitting.

### CAUTION

- Do not overtighten the nut.

- (5) Insert the packing in the tank water supply hose box nut and connect the tank water supply hose to the junction fitting.

### CAUTION

- Do not overtighten the nut.

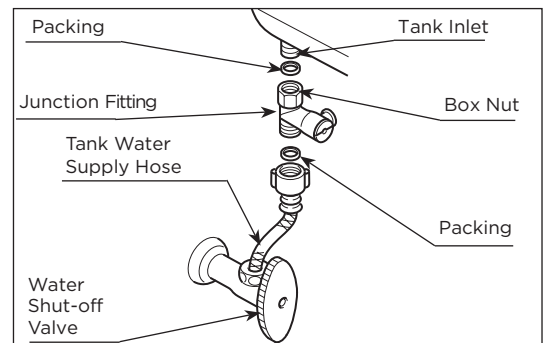
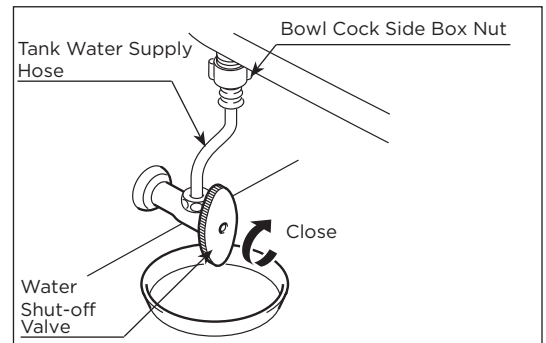

### 3. Installation of SpaLet® seat unit water supply hose to the SpaLet seat

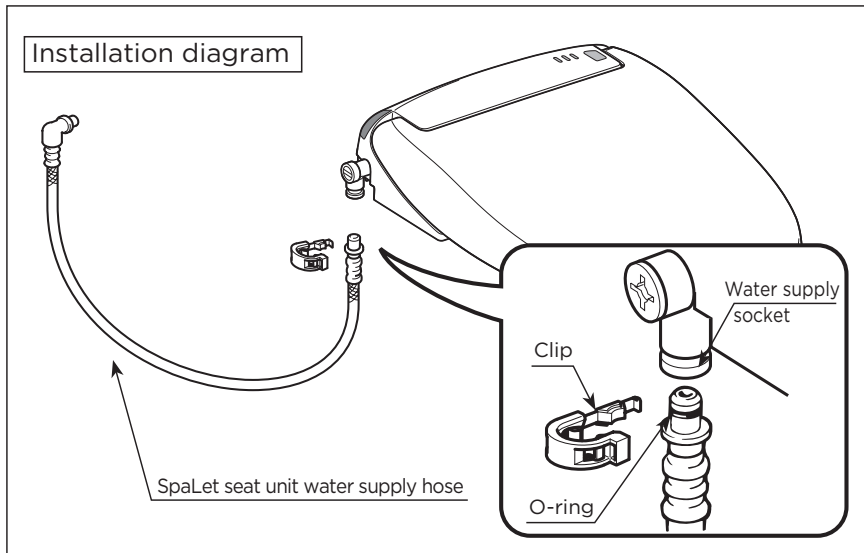

- 1) Remove the protective cover from the end of the SpaLet seat unit water supply hose, and pull out the cap from the water supply connection socket.
- 2) Connect the SpaLet seat unit water supply hose for the SpaLet seat to the water supply connection socket.

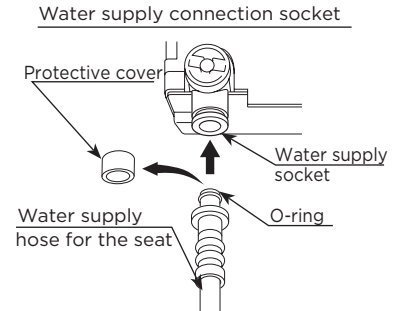

- 3) Insert the attachment clip onto the SpaLet seat unit water supply hose to attach it to the SpaLet seat and water supply connection socket.

\*The attachment clip can be attached in any direction.

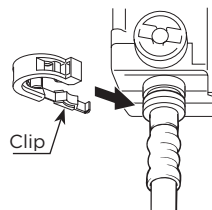

#### CAUTION

- Be careful not to damage the O-ring. Damaged O-ring may cause water to leak.

- 4) Bend the clip end and firmly clip together both the feeding hose for the SpaLet seat and the feeding socket. After you install the clip, twist it in both directions to verify that it is firmly attached.

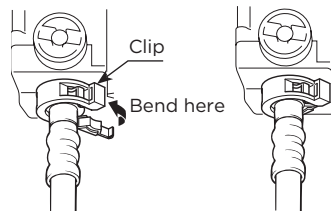

#### CAUTION

- Firmly insert the clip.  
\*If the clip is not firmly inserted, it may cause water to leak.

#### CAUTION

- Insert the clip until you feel the clip edge click.  
\*If not firmly inserted, it may cause water to leak.

- When removing the clip, hold the clip with your fingers, and using a flathead screwdriver, push the clip downward to remove it as shown in the figure below.

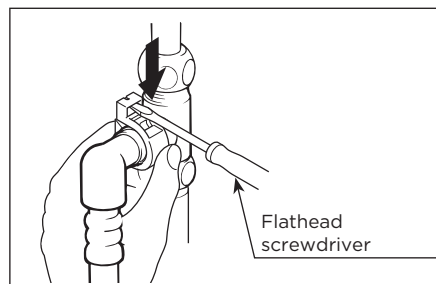

## 4. Installation of the SpaLet® seat

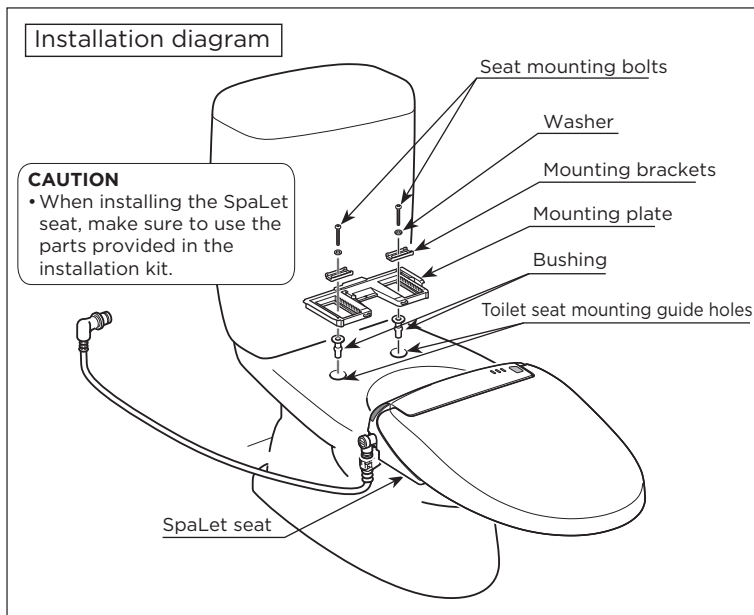

### (1) Remove the existing seat.

- 1) Remove the nuts from the seat mounting bolts, the slip washers, and rounded packing.
- 2) Raise the seat and remove it by lifting the seat mounting bolts.

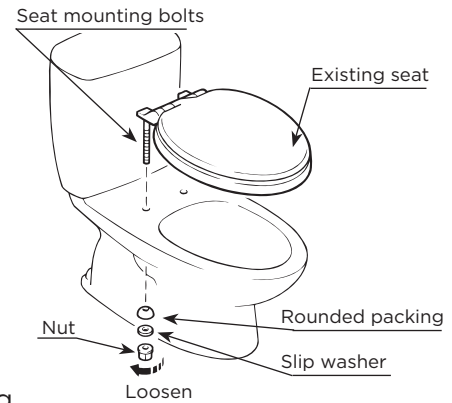

### (2) Install the slide plate onto the toilet bowl.

- 1) Insert the bushings into the seat mounting holes.
- 2) Insert the mounting bracket into the mounting plate and use the mounting bolts to attach the slide plate to the toilet bowl.

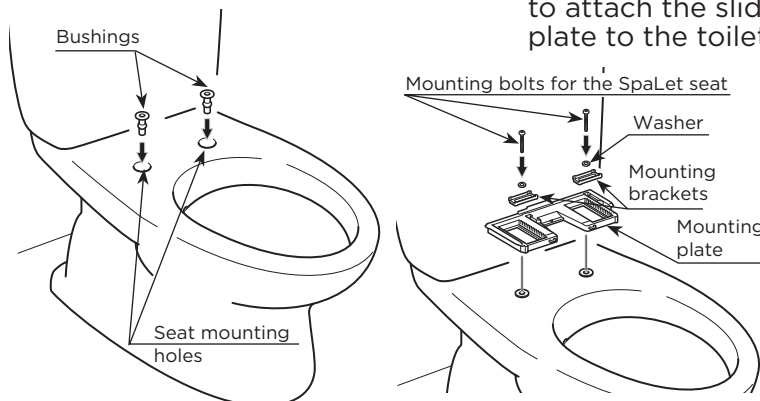

### References

- Some toilet seats may require different methods of removal that differ from our example.
- The removed toilet seat should be stored in your home in case you remove the SpaLet seat.

### (3) Install the SpaLet seat.

- 1) Place the SpaLet seat on the toilet bowl and align the ▽ mark on the mounting plate with the △ mark on the rear section of the SpaLet seat.
- 2) Slightly raise the front side of the SpaLet seat, slide it until the slide plate is fully inserted, and then press the locking lever to secure the SpaLet seat.

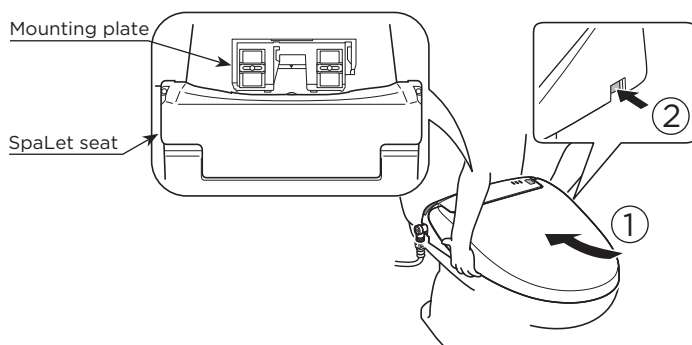

## 5. Install the SpaLet® seat unit water supply hose (junction fitting side)

- (1) Remove the protective cover from the end of the SpaLet seat unit water supply hose, and insert it in the junction fitting.

### CAUTION

- Be careful not to damage the O-ring.
- \*Water may leak if the O-ring is broken or damaged.

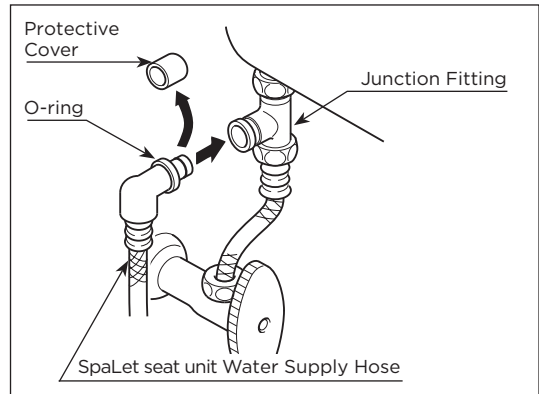
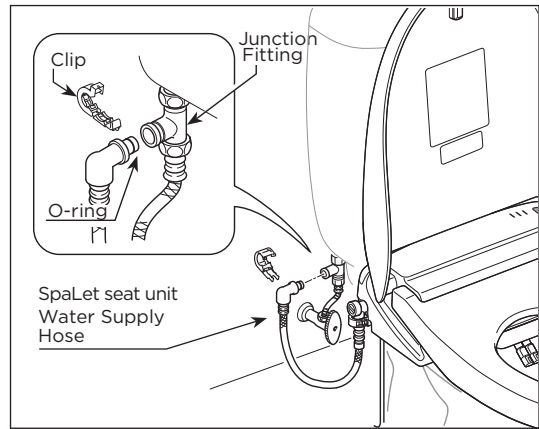

- (2) As with the body side, fit the clip on the hose and junction fitting and lock it. Turn it to make sure it is fastened securely.

- Fit the clip by engaging its ends until a click is heard.
- \*Loose fitting may cause water leakage.

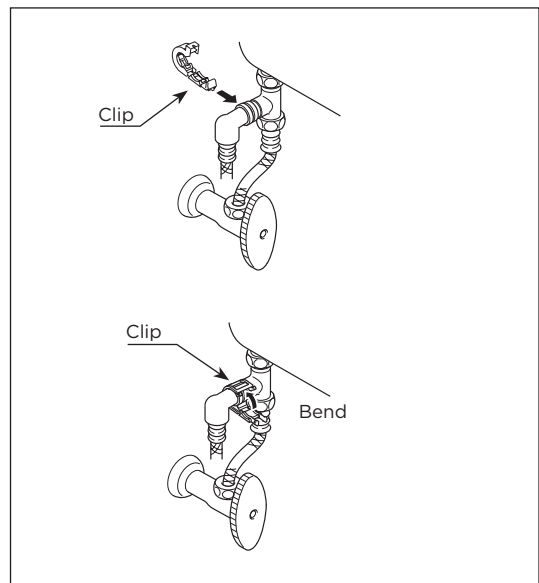

# 6. Positioning and Mounting the Remote Control

## Remote control installation position

Install the remote control to a position where the user can reach and operate it.

Install the remote control in the area shown as "Suggested installation area" in the figure below, and ensure to install the remote control on a position where it can be operated easily while the user is seated on the SpaLet® seat.

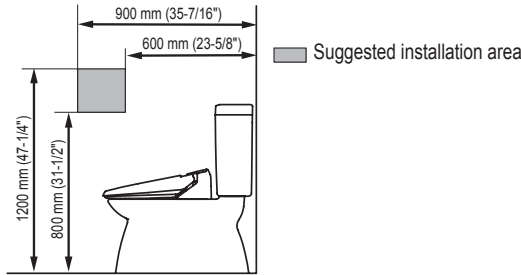

## Sit on the SpaLet seat and ensure the installation position. [See Note 7-1]

Temporarily install the remote control to the target position, and sit on the SpaLet seat unit and press the [Stop] button (ensure to perform a test operation after installation).

Then, stand in front of the toilet bowl and push the [Stop] button to ensure that a beep sound is generated from the SpaLet seat unit.

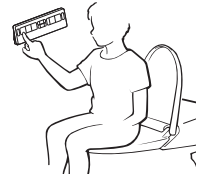

- Do not push the [Cleansing] or [Bidet] button: water would come out from the SpaLet seat unit.
- Ensure that there is enough space above the remote control installation position to allow easy removal and mount of the remote control.

## Installation Procedure

### 1. Installing the Batteries and Confirming the Remote Control Installation Position

1. Open the back cover of the remote control, and install the included batteries (AA x 2). [See Note 7-1]
  - \* Use a tool such as a flat-blade screwdriver to push the hook (lock) to remove the cover.
2. Confirm the remote control installation position.

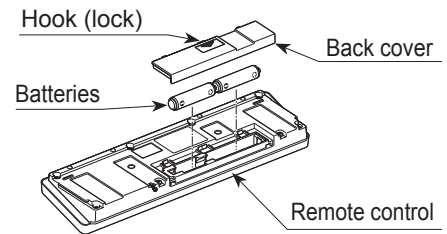

### 2. Mounting the Remote Control

1. Remove the holder from the remote control.
2. Install the holder to the installation position using an appropriate method for the wall. [See Note 7-2]

\* Out of 4 slots, use the outer 2 slots (with A marks). If the holder can be installed only with a hole pitch at 100 mm (3-15/16"), use the inner 2 slots.

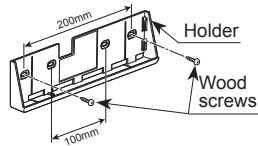

#### [For a plywood wall (> 5 mm (3/16") thick)]

Affix the holder firmly with the supplied wood screws.

#### [For a plywood wall (<5 mm (3/16") thick) or a plaster board wall]

- ① Make the pilot holes with 6 mm (1/4") diameter. (5 mm (3/16") diameter for a plaster board wall)
- ② Use a hammer to insert the supplied plastic anchors gently.
- ③ Affix the holder firmly with the wood screws.

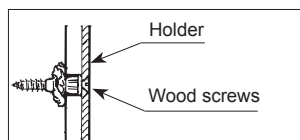
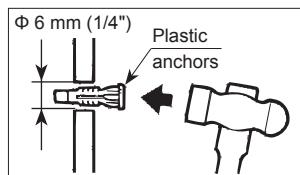

The wood screws are tight at the beginning, and then loosened once and tightened again.

#### [For a concrete wall]

- ① Make the pilot holes with 6 mm (1/4") diameter and approx. 33 mm (1-5/16") depth.
- ② Use a hammer to insert the supplied plastic anchors gently.
- ③ Affix the holder firmly with the wood screws.

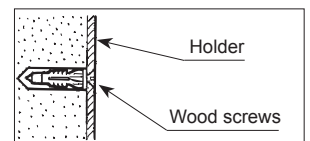
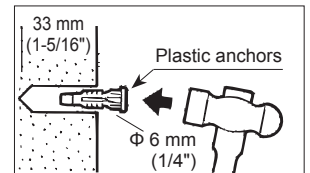

3. Align the remote control to the holder, and push downward to mount the remote control.

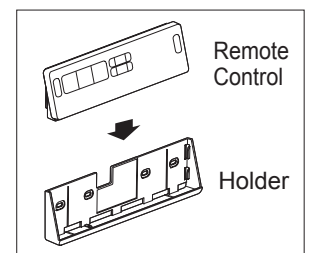

**[Note 7-1]**

- Ensure to install the batteries in the correct direction (note the negative and positive).
- Do not mix old and new batteries.
- Use the supplied batteries.

**[Note 7-2]**

- Ensure that there is enough space above the remote control installation position to allow easy removal and mount of the remote control (see the figure below).

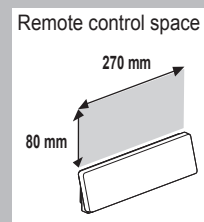

**When multiple SpaLet® seat units are installed:**

When multiple SpaLet seats are installed, a SpaLet seat in other booth may also respond to the signal and cause malfunction. To prevent this, you can change the signal using the remote control unit you purchased. Change both the emitting signal (remote control unit) and receiving signal (SpaLet seat).

**1. Changing emitting signal (remote control unit)**

- (1) Remove the batteries from the remote control unit.
- (2) Refer to the signal table on the right, hold down the desired button, insert the batteries and wait for six seconds (twenty seconds for Cleansing and Bidet button) with the button held down.
- (3) When the emitting signal has been changed, the battery mark on the lower right of the remote control flashes.  
(The number of flashes differs depending on the signal that has been changed.)

**2. Changing receiving signal (SpaLet seat)**

- (1) Remove the power plug of the SpaLet seat for which the signal is to be changed.
- (2) Insert the power plug again, and then press the [Stop] button at least 10 times within 10 seconds after insertion.

**NOTE:** Do not turn on and off the indoor (equipment) breaker to perform the above operation.

- \* If power is turned on simultaneously for multiple SpaLet seats, the receiving signal of other bidets may be changed.
- \* Some signals cannot be set on some products.

Signal Number	Operation Button	Battery Mark No. of Flashes
Signal 1	Water Temp	Once
Signal 2	Seat Temp	Twice
Signal 3	Power save	Three times
Signal 0	Nozzle Cleaning	Four times
Signal 4	Spray Strength -	Five times
Signal 5	Spray Strength +	Six times
Signal 6	Cleansing	Seven times
Signal 7	Bidet	Eight times

\* **Signal 0 is the default setting.**



# Test Operation

Follow the procedure below after the installation work has been completed.

## 1. Insert the power plug into the outlet.

Confirm that the power LED on the SpaLet® seat unit is lit.

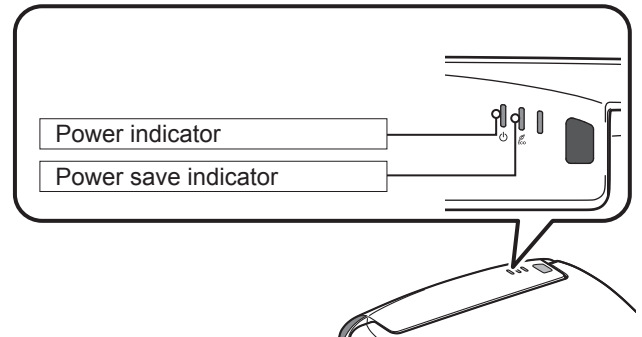
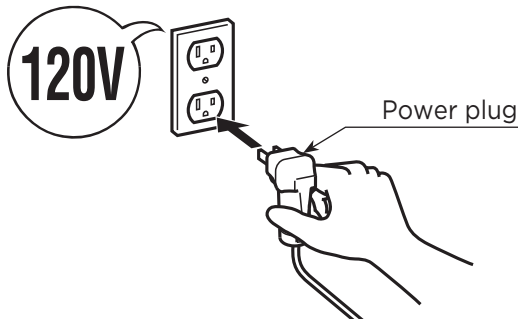

## 2. Check the front and back cleansing spray.

(1) Check the cleansing operation.

- 1) With your forearm resting on the SpaLet seat, press the Cleansing button. The spray automatically stops two minutes after the switch is turned on.
- 2) When the nozzle extends, cover the tip of the nozzle with your hand to catch the spray.
- 3) Press the [Stop] button to stop the cleansing spray.

(2) Perform the same check using the front cleansing spray function.

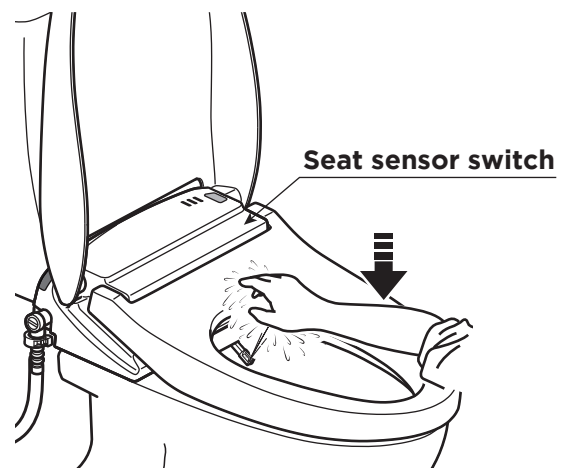

\*Due to the seat sensor function, the product's back cleansing, front cleansing and deodorizer will not operate unless you touch the seat.

### CAUTION

When removing the filter, be sure to close the water shut-off valve. When attaching the filter, firmly tighten it until the end of the filter is hidden in the SpaLet seat unit.

\* Water will leak from the filter.

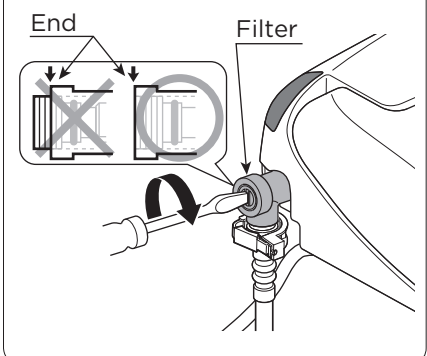

### 3. If the flushing begins to weaken, or if the nozzle spray seems to be getting weaker, clean the filters.

- (1) Turn the water shut-off valve clockwise to close it. As the water shut-off valve is pre-adjusted, keep track of the turns so that you can return to the original position.
- (2) Remove the filter located on the left side of the SpaLet® seat unit. Place a wash bowl or similar item underneath the Filter.
- (3) Rinse the filter.
- (4) Firmly tighten the filter.
- (5) Open the water shut-off valve by turning it back to its original position.

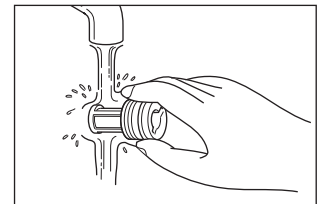
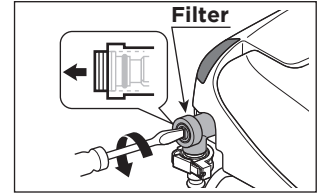
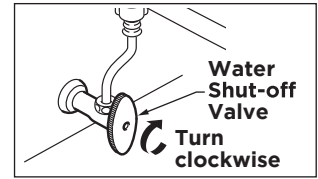

### 4. If freezing weather is anticipated, drain the water.

- (1) Close the water shut-off valve to shut-off the water supply.
  - \* If the open/close knob is difficult to turn, grasp it with a dry cloth and turn.
- (2) Move the flush lever to drain water from the toilet tank.
- (3) Drain the water from the water supply side.
  - ① Place a basin or similar beneath the strainer.
  - ② Remove the strainer, rinse away dirt that has attached to the strainer and O-ring, and then completely remove the part.
  - ③ Insert the power plug into an outlet.
  - ④ Press and hold both the [Massage] and [Nozzle Position <math>\leftarrow</math>] buttons for at least 2 seconds.
    - \* Remaining water in the toilet body will drain over a 15-second period.
  - ⑤ Disconnect the power plug from the outlet.
  - ⑥ After the water has been drained, securely reattach the strainer.
- (4) Check for leaks from the water shut-off valve.

