

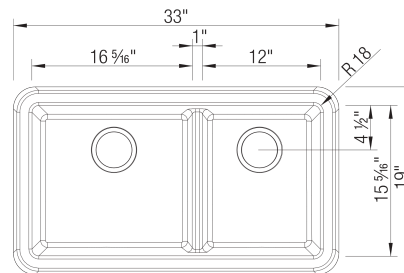

## Sink Specifications

Colour	SKU
Anthracite	402331
Cinder	402334
Metallic Gray	402335
Café	402333
White	402337
Truffle	402336
Coal Black	402645
Soft White	402873
Volcano Gray	402918

## IKON 33 1<sup>3</sup>/<sub>4</sub> Low Divide SILGRANIT



### Design and planning tips

- Min cabinet size: 36 in ( 915 mm )
- Apron front height: 10 in ( 254 mm )
- Rim thickness: 1.5 in ( 38 mm )

#### Specifications:

3 1/2" stainless steel strainer(s), Installation instructions, Cabinet template, Limited Lifetime Warranty

Custom cabinet installation required.  
To protect from damage, sink must ship on a pallet

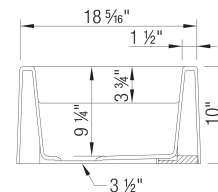
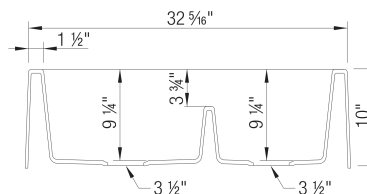

### Codes & Standards

CSA B45.8-18/ IAPMO Z403-2018

### Optional Accessories

Sink Grid	402339
CapFlow Strainer Cover	517666
Floating Grid	406533
Sink Grid	402340
Beech Cutting Board	235010

#### Warranty

Limited lifetime warranty on all sinks and faucets. One-year warranty on all accessories and soap dispensers.

#### Code/Standards Compliance

BLANCO sinks and faucets are third-party tested and certified to CSA, cUPC, ANSI/ASME, IAPMO and NSF standards and listed by applicable certification bodies. For more information on individual product listings, contact our office or listing organization.



Need support? Learn more by watching our sink & faucet How-to videos:

<https://www.blanco.com/ca-en/support/how-to-videos/how-to-videos-for-sinks/>



BLANCO Canada Inc  
100 Corporation Drive  
Brampton ON L6S 6B5

Tel & Fax  
Tel: 905-494-2400 Toll free: 1-877-425-2626  
Fax: 905-494-2425 Toll free: 1-877-825-2626

While BLANCO strives to provide accurate information, all images and dimensions in this document are intended for reference only and are subject to change at any time without notice. This document is not intended for use as an installation guide. For

---

technical installation details, refer to installation instructions provided with the product. BLANCO assumes no responsibility for the use of superseded or voided specifications.