



3-way Type T/P coaxial valve rough without cartridge
PEX
R95-SPEX



Specifications

Descriptions

- Rough only
- Three ½" outlets PEX
- ½" inlet PEX
- Test cap
- TXX95XX or TXX97XX trim required to complete
- Service valves

Certifications

- CSA B125.1
- ASME A112.18.1
- ASSE 1016
- CMR248 Approval

UPC®

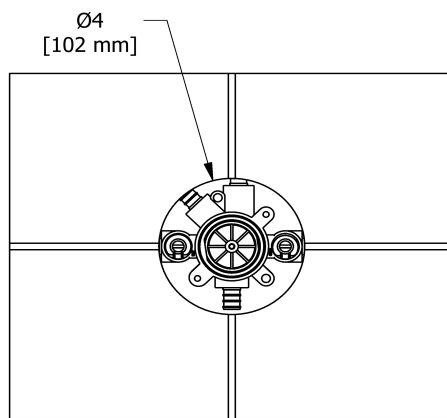
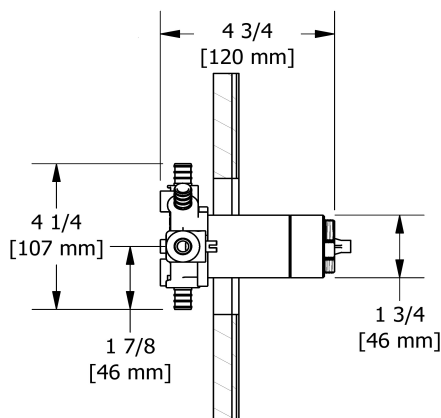

2 to/à 3 1/4
[51 mm to/à 83 mm]

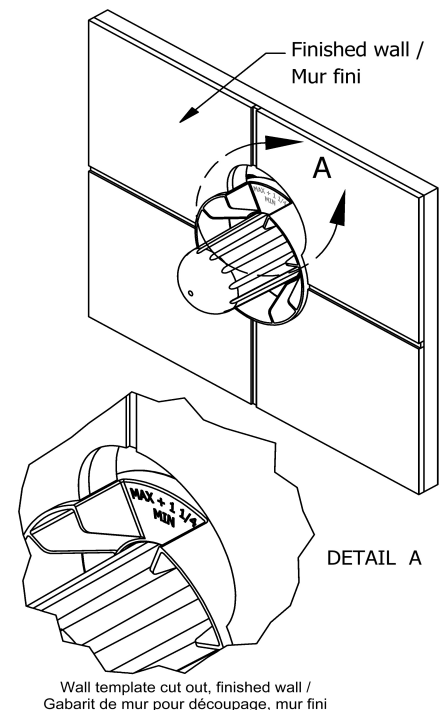
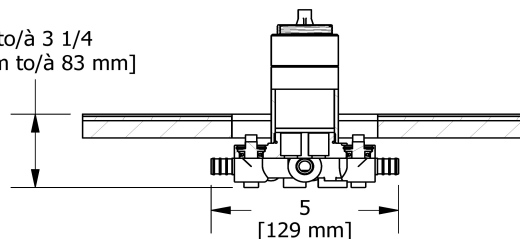

Sizes, models and finishes may differ from thoses presented.

Warranty

This **Riobel PRO**, product you have purchased carries a Limited LIFETIME warranty on their cartridge. All working parts and finishes are guaranteed for a period of five (5) years from the initial purchase date against all manufacturing defects. All electric and/or electronic parts are covered by a 5-years limited warranty. The warranty offered on our products will be honored only if the installation is performed by a certified master plumber.

Customer Service

Ontario, West Canada : 888-287-5354 Quebec, Maritimes, United States : 866-473-8442

2020.11.07