

WASTE BIN
RODX605E | 2000090062

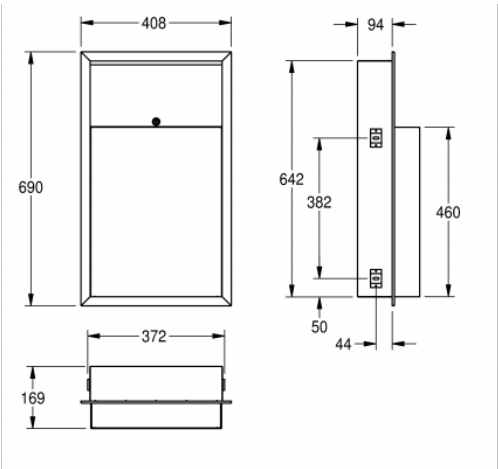

Waste bin for recessed mounting, stainless steel, surface satin finished, material thickness 22 gauge rounded edges, cylinder lock with Franke standard key, mounting with in-wall frame, including stainless steel screws and dowels.
Capacity: approx. 23 litre

TECHNICAL DATA	
bag clamp	no
filling volume	23.00 liter
gross weight	8.25 kg
lid	no
lock	key-lock
material	STAINLESS-STEEL
material code	1.4301 Chrome Nickel steel V2A
material thickness	1/16"
net weight	7.50 kg
Overall front to back	6 5/8"
overall height	27 3/16"
Overall left to right	16 1/16"
Cabinet finish	satin finished
type of fixing	screw
type of mounting	recessed mounting

PROJECT INFORMATION

Item Location

Project Number

Quote Number

Notes

Engineer's Approval

