

Denso 42 in. Solid Surface Glue up Two-Piece Wall Kit

Model number:	107228
---------------	--------

Dimensions:	42" x 0.25" x 84"	Installation:	Glue up	Material:	Solid Surface
-------------	-------------------	---------------	---------	-----------	---------------

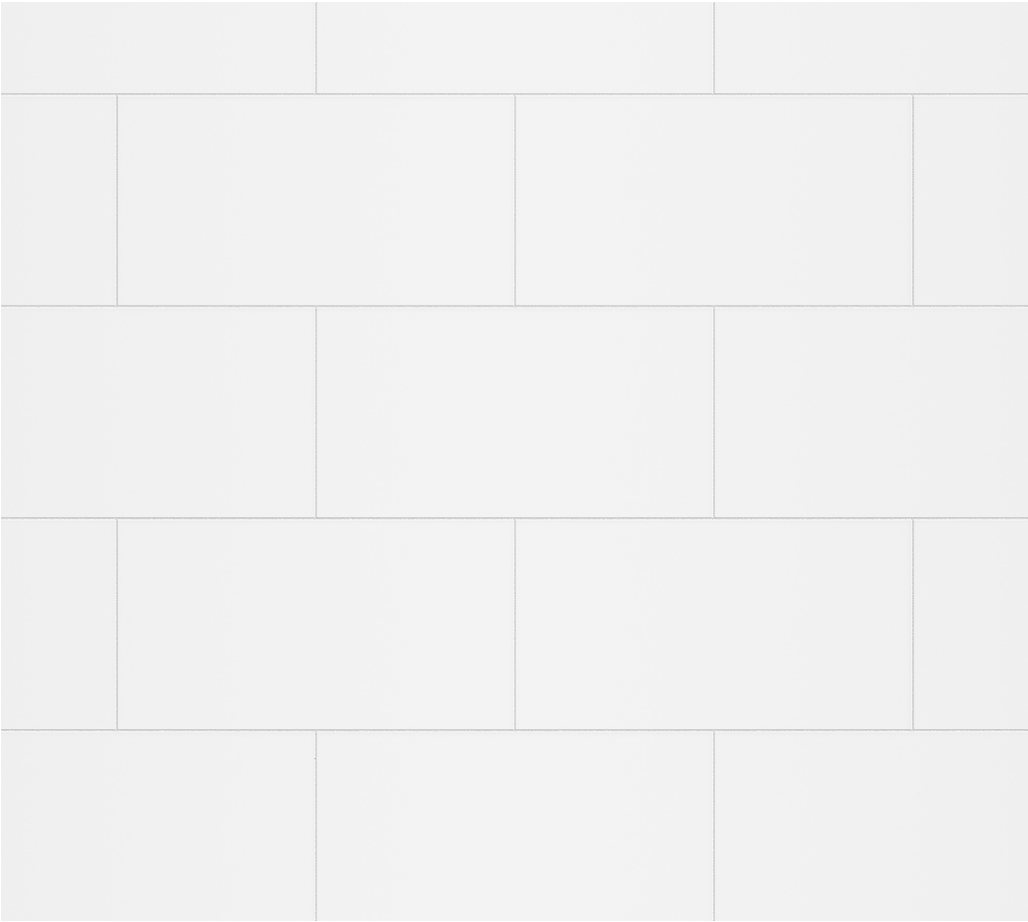

Standard Features:

- Perfect wall solution for corner showers up to 42 in. or pair it with a back wall for an alcove shower
- Realistic tile wall look made of durable solid surface material with textured grout lines
- Traditional 12" H x 24" W matte subway tile pattern
- Solid 1-piece wall panels that can be installed directly on drywall or over tile
- Walls can be easily cut to adapt to most shower spaces and fit on most products
- Can be paired with a choice of distinctive shelves for additional storage (sold separately)

Product characteristics:

- Easily Trim to Fit
- Traditional Subway Pattern
- Easy to Clean

Warranty:

15 Years

Standard Colors:



White (270)

Certifications

MAAX products adhere to one or more of the following certifications:



Recommended products (Visit our website for a complete list of our recommended products)

No	Description
<input type="checkbox"/> 137449	Radia Neo-round 38 x 38 x 71 ½ in. 6mm Sliding Shower Door for Corner Installation
<input type="checkbox"/> 137441	Radia Neo-angle 38 x 38 x 71 ½ in. 6mm Sliding Shower Door for Corner Installation
<input type="checkbox"/> 137442	Radia Neo-angle 40 x 40 x 71 ½ in. 6mm Sliding Shower Door for Corner Installation

Denso 42 in. Solid Surface Glue up Two-Piece Wall Kit

Model number:

107228

Dimensions: 42" x 0.25" x 84"

Installation: Glue up

Material: Solid Surface

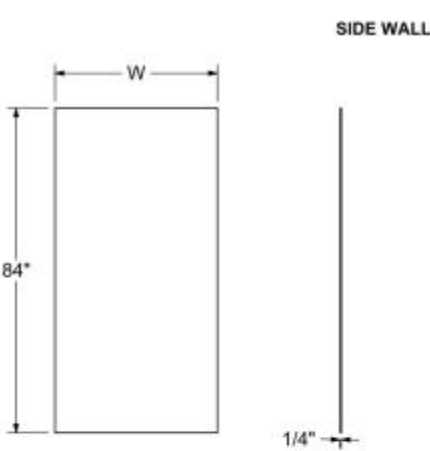

Code	Description	W (in.)
107223 / 107227	Denso 36" Side Wall	36
107224 / 107228	Denso 42" Side Wall	42

Available Patterns :

Modern Subway



Traditional Subway

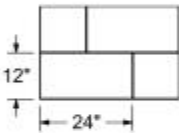

Dimensions

42 x 1/4 x 84 In.
(1067 x 6 x 2134 mm)

Weight

93 lbs - 42.27 kg

Corner

TOP VIEW (ASSEMBLED)

Alcove

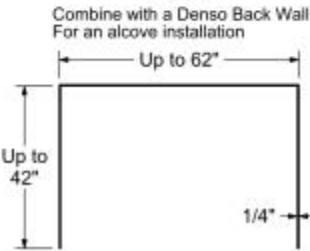
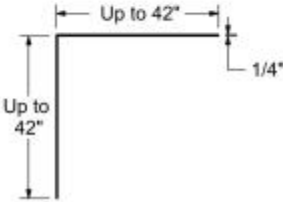

All dimensions are approximate. Structure measurements must be verified against the unit to ensure proper fit.

Project: _____

Contractor: _____

Representative: _____

Date: _____

Tel: _____

Notes: _____
