

Vero Furniture washbasin Y # 0329100000 / 0329100060

| < 41 3/8" Inch > |

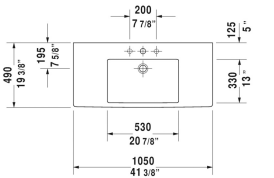

ADA Installation

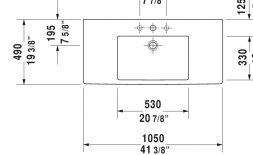
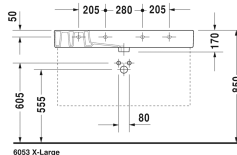
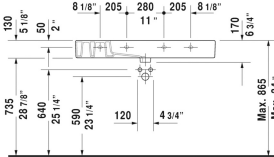

ADA Installation

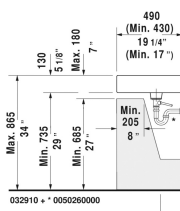

ADA Installation

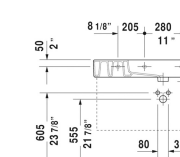

ADA Installation

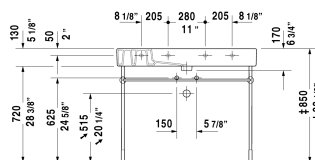
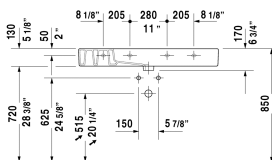

Furniture washbasin	Dimension	Weight	Order number
with faucet deck, underside fully glazed, wall-mounted, hardware included, cUPC listed, 41 3/8" Inch			
Colors			
00 White			
Variant			
● with overflow	41 3/8" x 19 1/4" Inch	71.4 lb	0329100000
☒ with overflow	41 3/8" x 19 1/4" Inch	71.4 lb	0329100060
Infobox			
When mounting ceramics larger than 39 3/8", 2 sets of basin hardware # 6951000000 are required, Washbasin is not ADA compliant in combination with pedestal, siphon cover or metal console			
Sanitary ceramics with the special WonderGliss surface finish will remain clean and attractive-looking for a long time to come. When ordering WonderGliss please add a "1" as eleventh digit to the model number.			
Metal console height adjustable +2", for furniture washbasin # 032910		7.3 lb	003072
Towel rail square tube 1/2", Chrome	39 3/4" Inch	1.3 lb	003035

Vero Furniture washbasin Y # 0329100000 / 0329100060

| < 41 3/8" Inch > |

Space-saving siphon	1 1/4" Inch	0.9 lb	005076
Design Siphon		3.3 lb	005036
Suitable products			
Vanity unit wall-mounted 1 pull-out compartment, 3 glass dividers, 2 box drawers large, 2 box drawers small, (not ground), for Vero # 032910, 39 3/8" x 18 1/4" / 15" Inch	39 3/8" x 18 1/4" / 15" Inch		F09573
Vanity unit wall-mounted 1 pull-out compartment, for Vero # 032910 (not ground), 39 3/8" x 17 7/8" Inch	39 3/8" x 17 7/8" Inch		KT6691
Vanity unit wall-mounted 2 drawers, upper drawer including cut-out for siphon and siphon cover, for Vero # 032910 (not ground), 39 3/8" x 17 7/8" Inch	39 3/8" x 17 7/8" Inch		KT6641
Vanity unit wall-mounted 2 drawers, upper drawer including cut-out for siphon and siphon cover, for Vero # 032910 (not ground), 39 3/8" x 18 1/2" Inch	39 3/8" x 18 1/2" Inch		DL6321
Vanity unit wall-mounted 1 pull-out compartment, compartment consists of glass dividers and 2 boxes (small/large), for Vero # 032910 (not ground), 39 3/8" x 18 3/8" Inch	39 3/8" x 18 3/8" Inch		XL6053
Vanity unit wall-mounted 2 drawers, upper drawer including cut-out for siphon and siphon cover, for Vero # 032910 (not ground), 39 3/8" x 18 3/8" Inch	39 3/8" x 18 3/8" Inch		XL6353
Vanity unit wall-mounted 1 opened compartment including towel rail, for Vero # 032910 (not ground), 39 3/8" x 17 1/2" Inch	39 3/8" x 17 1/2" Inch		VE6014
Vanity unit wall-mounted 1 pull-out compartment, pull-out compartment including cut-out for siphon and siphon cover, for Vero # 032910 (not ground), 39 3/8" x 17 1/2" Inch	39 3/8" x 17 1/2" Inch		VE6114
Vanity unit wall-mounted 2 drawers, upper drawer including cut-out for siphon and siphon cover, for Vero # 032910 (not ground), 39 3/8" x 17 1/2" Inch	39 3/8" x 17 1/2" Inch		VE6214
Vanity unit floorstanding 1 pull-out compartment, 2 drawers, upper drawer including cut-out for siphon and siphon cover, for Vero # 032910 (not ground), 39 3/8" x 17 1/2" Inch	39 3/8" x 17 1/2" Inch		VE6414
Vanity unit floorstanding 2 pull-out compartments, upper drawer including cut-out for siphon and siphon cover, for Vero # 032910 (not ground), 39 3/8" x 18 1/2" Inch	39 3/8" x 18 1/2" Inch		XL6544
Vanity unit floorstanding 3 drawers, upper drawer including cut-out for siphon and siphon cover, for Vero # 032910 (not ground), 39 3/8" x 18 1/2" Inch	39 3/8" x 18 1/2" Inch		XL6554
Vanity unit floorstanding 2 pull-out compartments, upper drawer including cut-out for siphon and siphon cover, plinth panel with integrated plinth leg (adjustable), for Vero # 032910 (not ground), 39 3/8" x 18 1/2" Inch	39 3/8" x 18 1/2" Inch		XL6564
Vanity unit floorstanding 3 drawers, upper drawer including cut-out for siphon and siphon cover, plinth panel with integrated plinth leg (adjustable), for Vero # 032910 (not ground), 39 3/8" x 18 1/2" Inch	39 3/8" x 18 1/2" Inch		XL6574

All drawings contain the necessary measurements which are subject to standard tolerances. They are stated in inch & mm and are non-

Vero Furniture washbasin Y # 0329100000 / 0329100060

|< 41 3/8" Inch >|

binding. Exact measurements, in particular for customized installation scenarios, can only be taken from the finished ceramic piece.