

WB1420U/5

WB1420U/5 | 2030011929

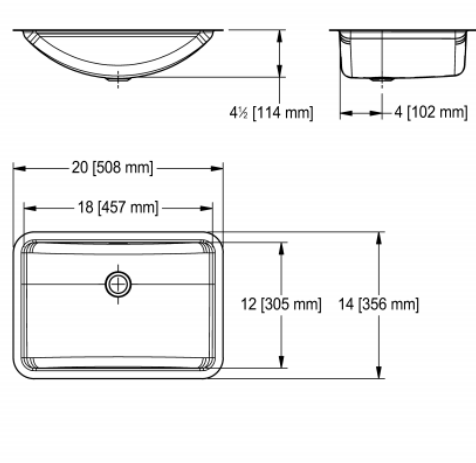

Single compartment undermount vanity basin. 18 gauge (1.2 mm), type 304 (CNS 18/10) stainless steel. Exposed surfaces are #4 satin finished. Undercoated to reduce condensation and resonance. Includes cutout template. Certified to ASME A112.19.3-2008 / CSAB45.4-08. Center back waste location, accepts 1 1/4" (32 mm) waste assembly (not included).

TECHNICAL DATA	
type of basin	vanity basin
bowl depth	4 1/2"
Bowl finish	SATIN-FINISHED
Bowl front to back	12"
Bowl left to right	18"
gross weight	5.04 kg
material	STAINLESS-STEEL
material thickness	1/16"
material thickness grade	18 gauge (1.2 mm)
noise prevention	yes
Overall front to back	14"
overall height	4 1/2"
Overall left to right	20"
overflow	no
Cabinet finish	satin finished
type of mounting	undermount
undercoated	yes
waste hole position	centre back
waste kit included	no
waste size	DN 32
net weight	4.34 kg
Faucet ledge	No

PROJECT INFORMATION

Item Location

Project Number

Quote Number

Notes

Engineer's Approval